

Connection hoses and cables	
Water hose:	✓
Waste water hose:	✗
Electric cable:	✓ 2x

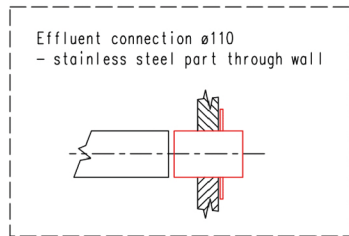
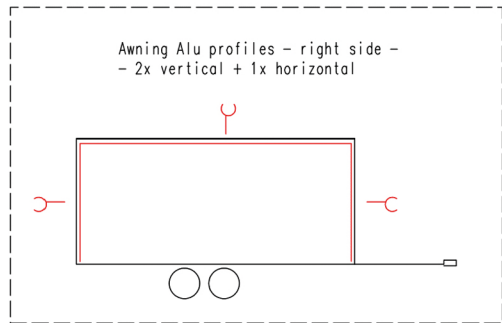
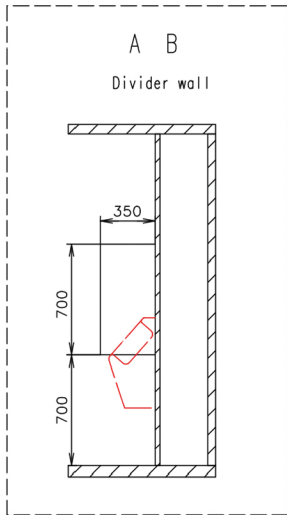
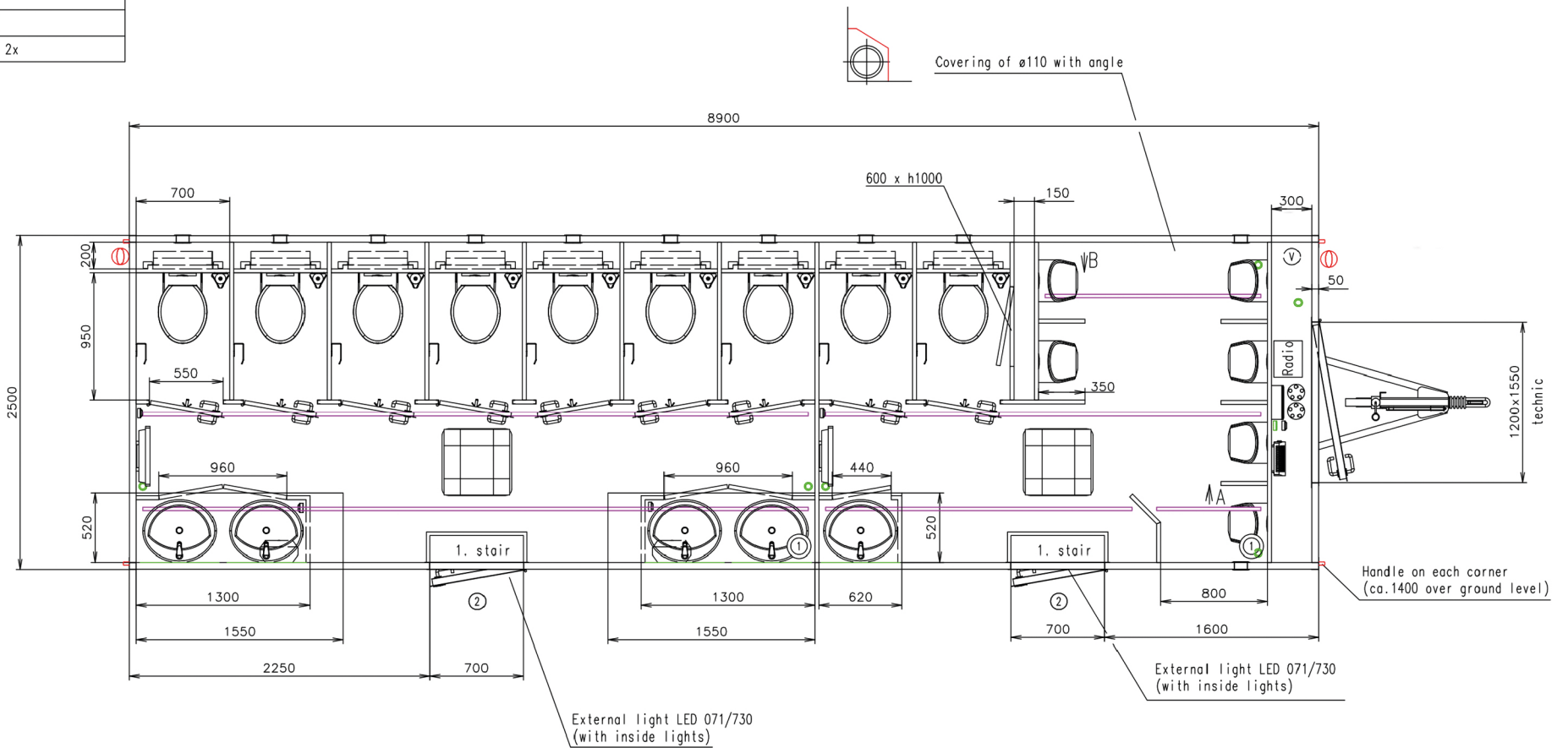

Working desks in waterproof compact desk Egger (dark color)

Interior doors + divider walls in black decor 6515

Notes: External doors - without cylinders Spare wheel - free loaded

Interior height:	2100 mm	Total weight:	3500 kg
Color:	RAL 7042	Tare weight-estimate:	3100 kg
Floor:	PVC Jupiter 148708	Centre of wheels from rear side:	4330 mm
Date:	1.12.2016	Wheels:	195/50 R13C



Drawing number:
2478-89-1_1/2 (Sprenger)

(Cabling and piping is not shown on the 3D views and drawings)

Connection hoses and cables	
Water hose:	✓
Waste water hose:	✗
Electric cable:	✓ 2x

- Ⓥ Water connection 3/4" (on the chassis) + filter + reduction valve
- Ⓜ 2x Electric connection (through the floor) (230V-16A) (1x heating) (1x the rest)
- Ⓢ 2x Effluent connection ø110 (through wall) - stainless steel part
- Ⓜ Power point
- Ⓛ Light switch
- Ⓜ Switch board (1200 over floor)
- Light LED stripe
- Heating (500W)
- ☰ Heating (750W)
- Floor drain hole
- ☰ Ventilation ø120
- Ⓢ Wash-basin (built-in) Multi 1690 (550x470) + standard water tap
- Ⓢ Hanging toilet (toilet seat - steel holders)
- Ⓢ Urinal - Vitra Siko (water flush)
- ☰ Hot water boiler Wterm FHN (5l)
- ☐ Roof window Dometic (400x400)
- ♻️ Brush toilet
- ☐ Toilet paper holder
- ↑ Clothes hanger
- Mirror (600x600) + black frame around
- ① Speaker
- ② Foldable stairs Fiona (update on fixing of stair) + stainless steel handrail

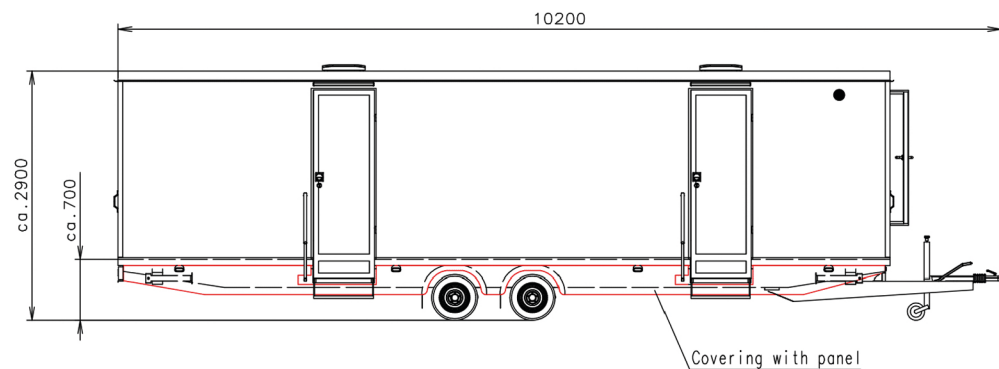

Working desks in waterproof compact desk Egger (dark color)

Interior doors + divider walls in black decor 6515

Notes: External doors - without cylinders Spare wheel - free loaded

Interior height:	2100 mm	Total weight:	3500 kg
Color:	RAL 7042	Tare weight-estimate:	3100 kg
Floor:	PVC Jupiter 148708	Centre of wheels from rear side:	4330 mm
Date:	1.12.2016	Wheels:	195/50 R13C

Sani Mobil

Drawing number:
2478-89-1_2/2 (Sprenger)

(Cabling and piping is not shown on the 3D views and drawings)